

ADVANCE NOTIFICATION SIGN MESSAGES

	ANS-3A (SOUTHBOUND ROUTE)	ANS-3B (NORTHBOUND ROUTE)
ADVANCE NOTIFICATION – TWO WEEKS PRIOR TO FULL CLOSURE	PRESTON TO BE CLOSED ST. ANTHONY–YOUNG DD MMM YY – DD MMM YY	PRESTON TO BE CLOSED YOUNG–ST. ANTHONY DD MMM YY – DD MMM YY
	PRESTON SERA FERMÉE ST. ANTHONY–YOUNG JJ MMM AA – JJ MMM AA	PRESTON SERA FERMÉE YOUNG–ST. ANTHONY JJ MMM AA – JJ MMM AA
ADVANCE WARNING – DURING FULL CLOSURE	PRESTON CLOSED ST. ANTHONY–YOUNG FOLLOW D-3	PRESTON CLOSED YOUNG–ST. ANTHONY FOLLOW D-4
	PRESTON FERMÉE ST. ANTHONY–YOUNG SUIVRE D-3	PRESTON FERMÉE YOUNG–ST. ANTHONY SUIVRE D-4

NOTES:

1. PLACEMENT OF TEMPORARY CONDITIONS SIGNAGE SHALL NOT OBSTRUCT MOTORISTS' VIEW OF EXISTING SIGNAGE.
2. MINIMUM SEPARATION BETWEEN ENGLISH AND FRENCH SIGNAGE SHALL BE 50m ON CITY STREETS.
3. ADVANCE NOTIFICATION SIGNS (ANS) TO BE INSTALLED 2 WEEKS PRIOR TO THE CLOSURE.
4. ADVANCE WARNING SIGNS (AWS) AND DETOUR TRAILBLAZER SIGNS (DTS) SHALL BE INSTALLED AND REMAIN IN PLACE DURING THE CLOSURE. TABS SHALL BE USED TO CHANGE SIGNS FROM ADVANCE NOTIFICATION TO ADVANCE WARNING.
5. PRESTON STREET FULL CLOSURE SHALL BE AS SPECIFIED ELSEWHERE IN THE CONTRACT.
6. SIGNAGE MAY REQUIRE COORDINATION WITH ADJACENT CONSTRUCTION ZONES. CONTRACTOR TO COORDINATE WITH CONTRACT ADMINISTRATOR.

METRIC

LEGEND

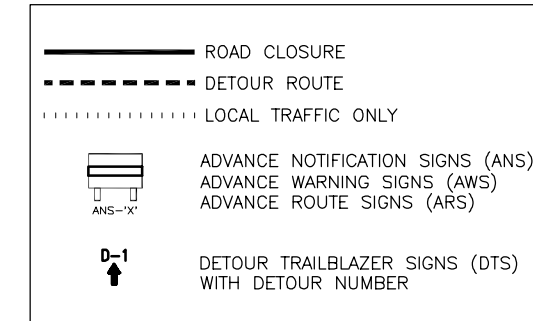
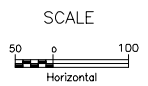
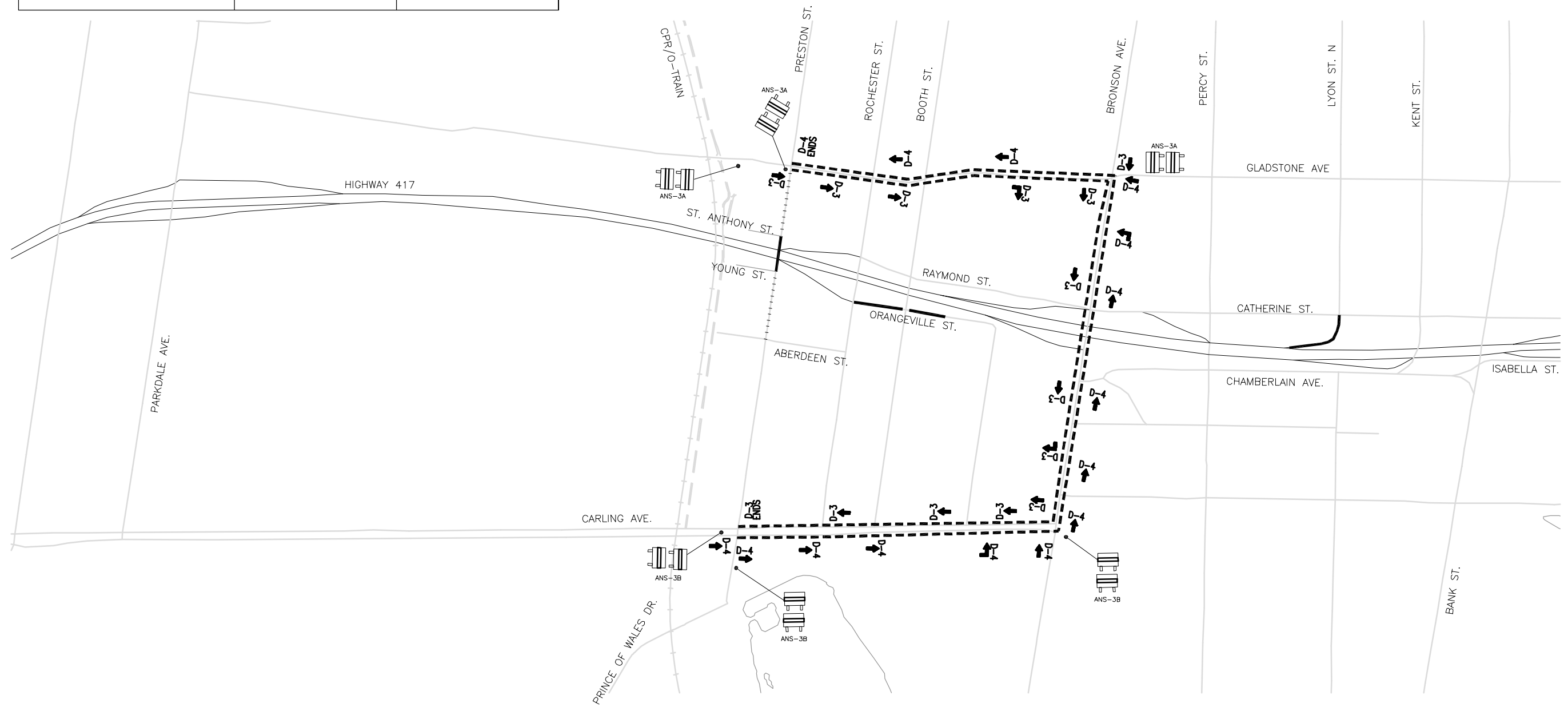
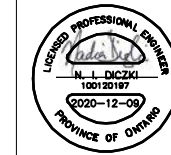

PLATE No
CONT No 2020-4075
WP No 4173-15-00



PRESTON FULL CLOSURE
DETOUR ROUTING

SHEET
17



FILE LOCATION: \\G00TT1\G00DATA1\0\3416024 HWY 417 MID-TOWN BRIDGES\CURRENT\SHEETS\
DRAWING NAME: 017-DETOUR PRESTON-SIDEROAD.DWG
DRAWN BY: S.C.
Revised 14:24:39
MODIFIED: 20/11/20

MINISTRY OF TRANSPORTATION, ONTARIO
PR-0-707 08-05