

METRIC

PLATE No  
**CONT No 2020-4075**  
**WP No 4173-15-00**



PRESTON CLOSURE  
 PEDESTRIAN AND CYCLIST  
 DETOUR ROUTING

SHEET  
 18

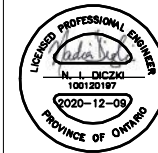

LEGEND	
	ROAD CLOSED
	PEDESTRIAN DETOUR ROUTE
	CYCLIST DETOUR ROUTE
	PEDESTRIAN AND CYCLIST DETOUR ROUTE
	DETOUR TRAILBLAZER SIGNS (DTS) (TC-40, TC-41, TC42)
	ADVANCE NOTIFICATION SIGNS (ANS) (TC-65)

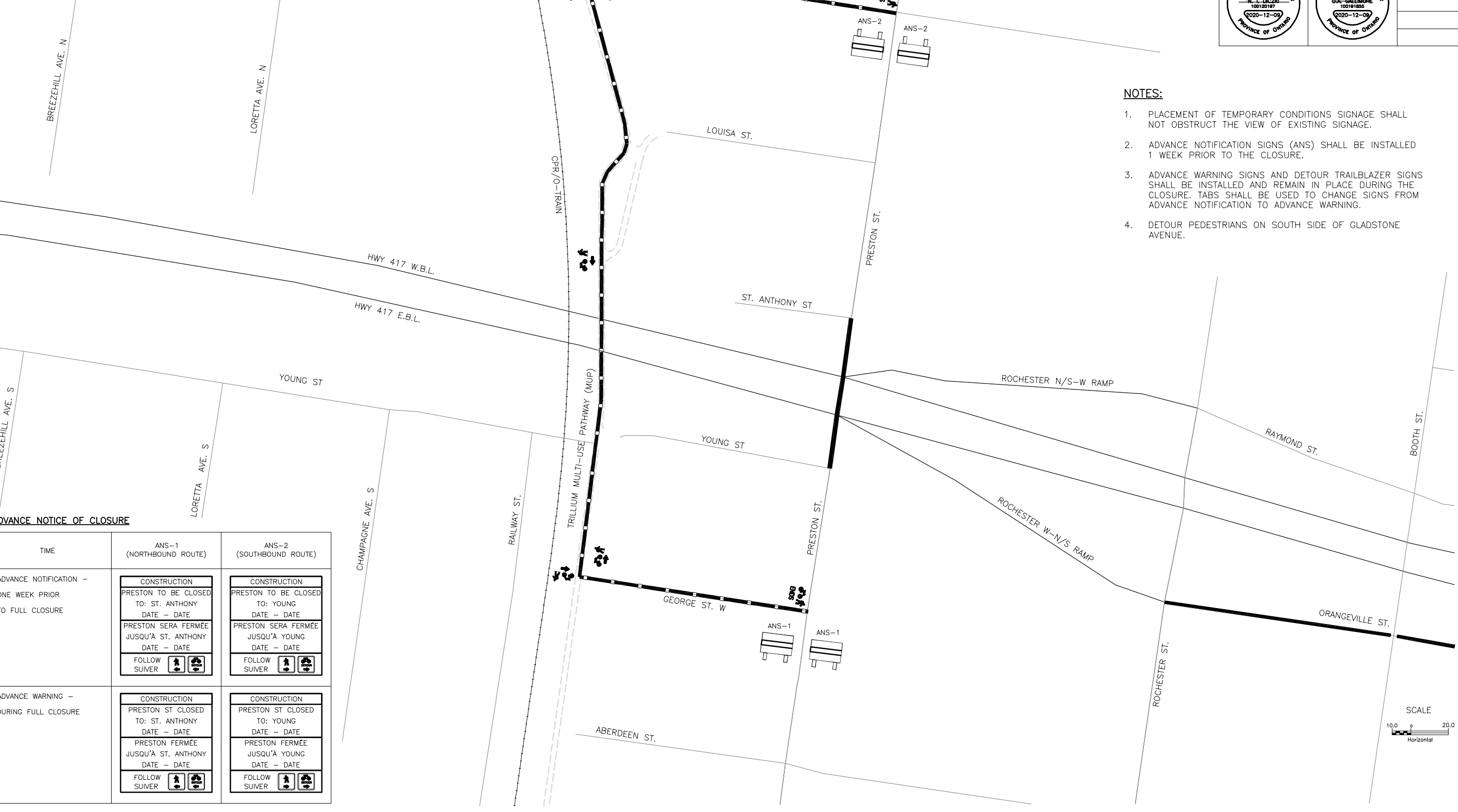

- NOTES:**
1. PLACEMENT OF TEMPORARY CONDITIONS SIGNAGE SHALL NOT OBSTRUCT THE VIEW OF EXISTING SIGNAGE.
  2. ADVANCE NOTIFICATION SIGNS (ANS) SHALL BE INSTALLED 1 WEEK PRIOR TO THE CLOSURE.
  3. ADVANCE WARNING SIGNS AND DETOUR TRAILBLAZER SIGNS SHALL BE INSTALLED AND REMAIN IN PLACE DURING THE CLOSURE. TABS SHALL BE USED TO CHANGE SIGNS FROM ADVANCE NOTIFICATION TO ADVANCE WARNING.
  4. DETOUR PEDESTRIANS ON SOUTH SIDE OF GLADSTONE AVENUE.

**ADVANCE NOTICE OF CLOSURE**

TIME	ANS-1 (NORTHBOUND ROUTE)	ANS-2 (SOUTHBOUND ROUTE)								
ADVANCE NOTIFICATION - ONE WEEK PRIOR TO FULL CLOSURE	<table border="1"> <tr><td>CONSTRUCTION</td></tr> <tr><td>PRESTON TO BE CLOSED TO: ST. ANTHONY DATE -- DATE</td></tr> <tr><td>PRESTON SERA FERMÉE JUSQU'À ST. ANTHONY DATE -- DATE</td></tr> <tr><td>FOLLOW SUIVER </td></tr> </table>	CONSTRUCTION	PRESTON TO BE CLOSED TO: ST. ANTHONY DATE -- DATE	PRESTON SERA FERMÉE JUSQU'À ST. ANTHONY DATE -- DATE	FOLLOW SUIVER	<table border="1"> <tr><td>CONSTRUCTION</td></tr> <tr><td>PRESTON TO BE CLOSED TO: YOUNG DATE -- DATE</td></tr> <tr><td>PRESTON SERA FERMÉE JUSQU'À YOUNG DATE -- DATE</td></tr> <tr><td>FOLLOW SUIVER </td></tr> </table>	CONSTRUCTION	PRESTON TO BE CLOSED TO: YOUNG DATE -- DATE	PRESTON SERA FERMÉE JUSQU'À YOUNG DATE -- DATE	FOLLOW SUIVER
CONSTRUCTION										
PRESTON TO BE CLOSED TO: ST. ANTHONY DATE -- DATE										
PRESTON SERA FERMÉE JUSQU'À ST. ANTHONY DATE -- DATE										
FOLLOW SUIVER										
CONSTRUCTION										
PRESTON TO BE CLOSED TO: YOUNG DATE -- DATE										
PRESTON SERA FERMÉE JUSQU'À YOUNG DATE -- DATE										
FOLLOW SUIVER										
ADVANCE WARNING - DURING FULL CLOSURE	<table border="1"> <tr><td>CONSTRUCTION</td></tr> <tr><td>PRESTON ST CLOSED TO: ST. ANTHONY DATE -- DATE</td></tr> <tr><td>PRESTON FERMÉE JUSQU'À ST. ANTHONY DATE -- DATE</td></tr> <tr><td>FOLLOW SUIVER </td></tr> </table>	CONSTRUCTION	PRESTON ST CLOSED TO: ST. ANTHONY DATE -- DATE	PRESTON FERMÉE JUSQU'À ST. ANTHONY DATE -- DATE	FOLLOW SUIVER	<table border="1"> <tr><td>CONSTRUCTION</td></tr> <tr><td>PRESTON ST CLOSED TO: YOUNG DATE -- DATE</td></tr> <tr><td>PRESTON FERMÉE JUSQU'À YOUNG DATE -- DATE</td></tr> <tr><td>FOLLOW SUIVER </td></tr> </table>	CONSTRUCTION	PRESTON ST CLOSED TO: YOUNG DATE -- DATE	PRESTON FERMÉE JUSQU'À YOUNG DATE -- DATE	FOLLOW SUIVER
CONSTRUCTION										
PRESTON ST CLOSED TO: ST. ANTHONY DATE -- DATE										
PRESTON FERMÉE JUSQU'À ST. ANTHONY DATE -- DATE										
FOLLOW SUIVER										
CONSTRUCTION										
PRESTON ST CLOSED TO: YOUNG DATE -- DATE										
PRESTON FERMÉE JUSQU'À YOUNG DATE -- DATE										
FOLLOW SUIVER										

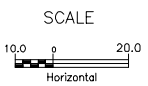

FILE LOCATION: \\G00TT100D01\0\3416024 HWY 417 MID-TOWN BRIDGES\CURRENT SHEETS\  
 DRAWING NAME: 018-DETOUR PRESTON-CYCLIST.DWG  
 DRAWN BY: S.C.  
 Modified: 20/11/20  
 14:23:56

MINISTRY OF TRANSPORTATION, ONTARIO  
 PE-0-707 08-05